

精密鎖定螺帽之參考數據

螺 牙 Thread	軸向負載能力 Axial Load Static kN	扭緊力矩 Tightening Torque Max. Nm	鬆 脫 力 矩 Loosening Torque Nm			
			YSF	YSA	YSR	YSK
M8	30	4.5	—	—	17.6	—
M10	35	4.5	—	—	18.1	—
M12	40	4.5	—	—	19.1	—
M15	60	4.5	—	—	20.6	—
M17	80	8	27.5	24.5	21.6	90.0
M20	90	8	28.9	26.0	24.0	99.0
M25	130	8	30.4	27.5	26.5	101.0
M30	160	8	32.4	29.4	28.4	102.0
M35	190	18	39.2	37.3	34.3	109.8
M40	210	18	46.1	42.2	36.3	110.8
M45	240	18	61.8	58.8	56.9	127.5
M50	300	18	70.6	65.7	63.7	137.3
M55	340	18	88.2	73.5	68.6	166.7
M60	380	18	98.0	81.4	96.1	205.9
M65	460	18	127.5	88.2	112.7	254.9
M70	490	18	147.1	96.1	137.3	313.7
M75	520	18	152.0	102.9	145.1	382.4
M80	620	18	156.9	112.7	149.0	460.8
M85	650	18	176.5	127.5	168.6	549.0
M90	680	18	186.3	137.3	178.4	656.9
M95	710	18	201.0	152.0	193.1	745.1
M100	740	18	220.6	171.6	210.8	833.3
M105	770	35	236.3	186.3	215.7	957.2
M110	800	35	252.0	205.9	230.4	1127.5
M115	830	35	268.1	220.6	250.0	1242.3
M120	860	35	279.4	235.3	264.7	1323.5
M125	890	35	289.2	250.0	274.5	1389.4
M130	920	35	313.7	264.7	294.1	1421.5
M135	950	35	352.9	303.9	328.4	1576.0
M140	980	35	392.2	323.5	372.5	1610.3
M145	1010	35	436.3	352.9	402.0	1680.4
M150	1040	35	480.4	392.2	421.6	1710.0
M155	1070	35	519.6	421.6	460.8	1850.2
M160	1100	35	563.7	460.8	509.8	1931.1
M165	1130	35	598.0	495.1	529.4	1989.2
M170	1160	35	647.1	519.6	558.8	2052.0
M180	1220	60	686.3	558.8	558.2	2214.1
M190	1280	60	735.3	598.0	627.5	2596.4
M200	1340	60	794.1	637.3	666.7	2731.2

Remarks:(1)The data are for reference only. (2)1 Nm=10.2kgf.cm=0.73lb.ft

YSF 牙腹鎖定

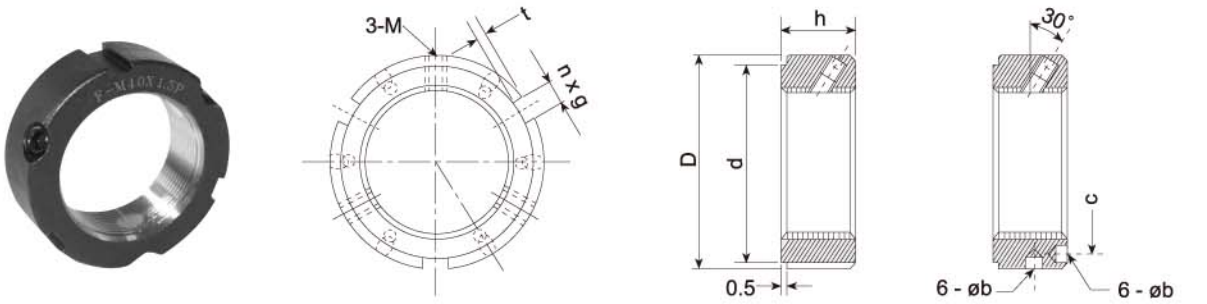

單位(unit):mm

螺 牙 Thread	D	h	d	n x g / b	t / c		M	MAX.Nm
YSF-M 17X1	32	16	27	3 x 4 / -	2	—	M5	4.5
YSF-M 20X1	38		33		2	—		
YSF-M 20X1.5			33		2	—	M6	8.0
YSF-M 25X1.5		18	33	2	—			
YSF-M 30X1.5	45		40	2	—			
YSF-M 35X1.5	52		47	2	—	M8	18.0	
YSF-M 40X1.5	58	20	52	2.5	—			
YSF-M 45X1.5	65		59	2.5	—			
YSF-M 50X1.5	70		64	2.5	—			
YSF-M 55X2	75	22	68	2.5	65			
YSF-M 60X2	80		73		70			
YSF-M 65X2	85		78		75			
YSF-M 70X2	92	24	84	3.5	81			
YSF-M 75X2	98		90		87			
YSF-M 80X2	105		96		93			
YSF-M 85X2	110	26	102	6 x 8 / ϕ 7	98			
YSF-M 90X2	120		108		105			
YSF-M 95X2	125		113		110			
YSF-M 100X2	130	28	118	6 x 10 / ϕ 7	115			
YSF-M 105X2	140		125		123			
YSF-M 110X2	145		132		128			
YSF-M 115X2	150	30	137	6 x 12 / ϕ 7	133			
YSF-M 120X2	155		142		138			
YSF-M 125X2	160		147		143			
YSF-M 130X2	165	152	148					
YSF-M 135X2	175	32	160		155			
YSF-M 140X2	180		165		160			
YSF-M 145X2	190		175	168				
YSF-M 150X2	195	34	180	6 x 14 / ϕ 8	173			
YSF-M 155X3	200		180		178			
YSF-M 160X3	210		190		185			
YSF-M 165X3	210		190		188			
YSF-M 170X3	220	36	200	6 x 16 / ϕ 8	195			
YSF-M 180X3	230		205		205			
YSF-M 190X3	240		215		215			
YSF-M 200X3	250	38	225		225	M12	60.0	

Remarks:(1)The data are for reference only. (2)1 Nm=10.2kgf.cm=0.73lb.ft