

Screw shaft diameter  $\phi 10$ , Lead 4

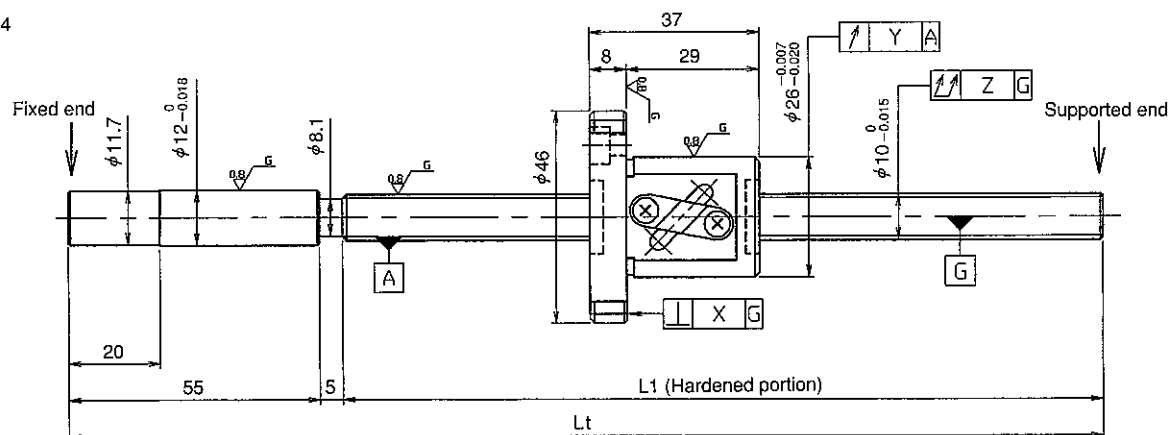
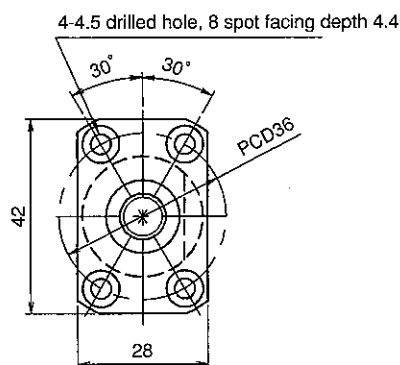

(Unit : mm)

Model No.	Axial clearance	L <sub>i</sub>	L <sub>t</sub>	X	Y	Z	Preload torque (N・cm)	Lead accuracy			Wiper	Mass (kg)
								±Ec	ec	e300		
GE1004DS-BAPR-0255A	~0.030 (M)	195	255	0.014	0.020	0.080	—	0.05	—	—	Plastics wiper	0.42
GE1004DS-BAPR-0385A		325	385			0.100						0.46
GE1004DS-BAPR-0455A		395	455			0.120						0.50
*GG1004DS-BAPR-0255A	~0.005 (F)	195	255	0.010	0.012	0.055	~1.0	0.023	0.018	0.018		0.42
*GG1004DS-BAPR-0385A		325	385			0.065		0.025	0.020			0.46
*GG1004DS-BAPR-0455A		395	455			0.080		0.025	0.020			0.50

●Standard length shaft without end machining

GG1004DS-BAPR-□□□□A

●With end machining specified on your drawing

GE1004DS-□A□R-□□□□X□□□□-C7M

GG1004DS-AR-X-C5

Overall length	Thread length
1.00	0.50
1.25	0.75
1.50	1.00
1.75	1.25
2.00	1.50
2.25	1.75
2.50	2.00
2.75	2.25
3.00	2.50
3.25	2.75
3.50	3.00
3.75	3.25
4.00	3.50
4.25	3.75
4.50	4.00
4.75	4.25
5.00	4.50
5.25	4.75
5.50	5.00
5.75	5.25
6.00	5.50
6.25	5.75
6.50	6.00
6.75	6.25
7.00	6.50
7.25	6.75
7.50	7.00
7.75	7.25
8.00	7.50
8.25	7.75
8.50	8.00
8.75	8.25
9.00	8.50
9.25	8.75
9.50	9.00
9.75	9.25
10.00	9.50
10.25	9.75
10.50	10.00
10.75	10.25
11.00	10.50
11.25	10.75
11.50	11.00
11.75	11.25
12.00	11.50
12.25	11.75
12.50	12.00
12.75	12.25
13.00	12.50
13.25	12.75
13.50	13.00
13.75	13.25
14.00	13.50
14.25	13.75
14.50	14.00
14.75	14.25
15.00	14.50
15.25	14.75
15.50	15.00
15.75	15.25
16.00	15.50
16.25	15.75
16.50	16.00
16.75	16.25
17.00	16.50
17.25	16.75
17.50	17.00
17.75	17.25
18.00	17.50
18.25	17.75
18.50	18.00
18.75	18.25
19.00	18.50
19.25	18.75
19.50	19.00
19.75	19.25
20.00	19.50
20.25	19.75
20.50	20.00
20.75	20.25
21.00	20.50
21.25	20.75
21.50	21.00
21.75	21.25
22.00	21.50
22.25	21.75
22.50	22.00
22.75	22.25
23.00	22.50
23.25	22.75
23.50	23.00
23.75	23.25
24.00	23.50
24.25	23.75
24.50	24.00
24.75	24.25
25.00	24.50
25.25	24.75
25.50	25.00
25.75	25.25
26.00	25.50
26.25	25.75
26.50	26.00
26.75	26.25
27.00	26.50
27.25	26.75
27.50	27.00
27.75	27.25
28.00	27.50
28.25	27.75
28.50	28.00
28.75	28.25
29.00	28.50
29.25	28.75
29.50	29.00
29.75	29.25
30.00	29.50
30.25	29.75
30.50	30.00
30.75	30.25
31.00	30.50
31.25	30.75
31.50	31.00
31.75	31.25
32.00	31.50
32.25	31.75
32.50	32.00
32.75	32.25
33.00	32.50
33.25	32.75
33.50	33.00
33.75	33.25
34.00	33.50
34.25	33.75
34.50	34.00
34.75	34.25
35.00	34.50
35.25	34.75
35.50	35.00
35.75	35.25
36.00	35.50
36.25	35.75
36.50	

- JIS B 1192-1987 (GG series) applies to accuracy standard values shown in the above-mentioned table.
- Support unit : BUK-8A (BUK-8F, BUK-6S) and BUM-8 is recommended. (Refer to P.398)
- Product with axial clearance ~0.005 (F) shown in the table may be partially preloaded.
- Preload torque shown in the table is a value before greasing.
- The grease is contained inside of nut only at the time of delivery. When using it, apply lubricant.
- For asterisked \* model with unworked shaft ends equivalent to lead accuracy grade C3, contact KURODA.

### Table of optional specifications for each model

Series	Additional machining of shaft end	Axial clearance adjustment (Note 2)	Surface treatment (Note 1)	Difference of grease	Direction of nut	Wiper removal
GE	○	×	○	○	○	○
GG	○	○	○	○	○	○

(Note 1) The above-mentioned surface treatment is LD treatment (coating thickness : 1 to 2  $\mu\text{m}$ ).

(Note 2) For axial clearance adjustment for GG series, contact KURODA.

### Ball screw specifications

<b>Screw shaft dia.</b>	<b>10</b>	<b>Axial clearance</b>	~0.030 (M) ~0.005 (F)
<b>Lead</b>	<b>4</b>	<b>Basic dynamic load rating</b>	3350N
<b>Thread direction</b>	<b>Right-hand</b>	<b>Basic static load rating</b>	5900N
<b>Number of circuits</b>	<b>2.5turn 1circuit</b>	<b>Spacer ball</b>	—
<b>Ball diameter</b>	<b>2.3812</b>	<b>Lubricant</b>	Alvania Grease No.2