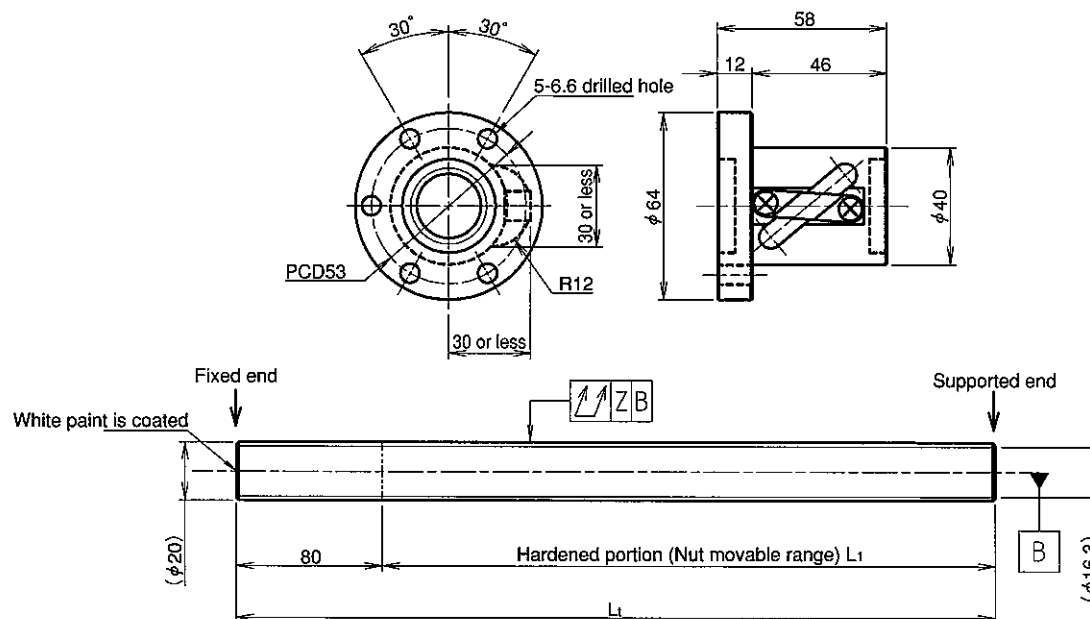

**KURODA** Standard Rolled Ball Screw : GY Series (Accuracy grade C10)

**UNFINISHED SHAFT ENDS**

 Screw shaft diameter  $\phi 20$ , Lead 10 (T nut)

(Unit : mm)

**Ball screw specifications**

Screw shaft dia.	20	Basic dynamic load rating	10600N
Lead	10	Basic static load rating	22700N
Thread direction	Right-hand	Lubricant	Alvania Grease No.2
Number of circuits	2.5turn 1circuit	Surface treatment	Phosphate coating
Ball diameter	4.7625		

Model No.	Axial clearance	L <sub>1</sub>	L <sub>t</sub>	Z	Wiper
GY2010DS-CTLR-0600A	~0.150	520	600	0.140	Lip seal
GY2010DS-CTLR-1200A		1120	1200	0.240	
GY2010DS-CTLR-2000A		1920	2000	0.640	

**Table of optional specifications for each model**

Additional machining of shaft end	Surface treatment (Note 1)	Difference of grease	Direction of nut	Wiper removal
○	○	○	○	○

(Note 1) The above-mentioned surface treatment is LD treatment (coating thickness : 1 to 2  $\mu$ m).

**Notation of standard rolled ball screw**

● Standard length shaft without end machining (Matched screw shaft and nut)

GY2010DS-CTLR-□□□□A

● Nut only without screw shaft

GY2010DS-CTLR

● Screw shaft only without end machining

GY2010ZZ-ZZZZ-□□□□D

● With end machining specified on your drawing (Matched screw shaft and nut)

GY2010DS-CTLR-□□□□X□□□□-CAY

● With end machining specified on your drawing (Screw shaft only)

GY2010ZZ-ZZZZ-□□□□Y□□□□-CAY

Overall length    Thread length